

Clean Water ~ Green Spaces



Rural and Agricultural Landowner Grants

Water Quality & Natural Areas Restoration Grant Program



Clean Water ~ Green Spaces Water Quality Enhancement & Natural Areas Restoration Program

Eligibility Guidelines

You May Qualify for Funding

Grants are available to landowners to implement projects which will help improve local water quality, reduce soil erosion, and increase natural areas cover. The following grant rates and maximums apply to all projects. A \$102.00 per acre minimum cash contribution is required for all tree planting projects (not including Buffer strips and wind breaks). **All projects must be pre-approved before work is started.**

Eligible Projects	Grant Rate ^{1,4}	Maximum Grant	Staff Contacts 519-776-5209 Fax: 519-776-8688
Buffer strips and wind breaks	Up to 75%	\$3,000	Michael Dick ext 369 mdick@erca.org
Tree planting ^{2,3}	Up to 90%	no maximum	Robert Davies rdavies@erca.org
Tree planting ^{2,3} , prairie or meadow establishment, wetland enquiries	Up to 90%	no maximum	Kate Arthur ext 303 karthur@erca.org
Soil erosion control structures (e.g., rock chutes, header tile retrofits, etc.)	Up to 75%	\$3,000	Michael Dick ext 369 mdick@erca.org
Water Well capping	Up to 50%	\$1,500	Michael Dick ext 369 mdick@erca.org

¹ In kind landowner contributions are eligible for tree planting, buffer strip, and wind break projects larger than 1 acre (0.4 hectare), and soil erosion control structures. In kind landowner contributions are ineligible for all other projects.

² All projects must include a minimum of 500 native trees or shrubs.

³ A minimum \$102.00 per acre contribution applies for block tree planting projects.

⁴ All projects applying for Environmental Farm Plan grants will be funded at a 50% rate.

Program Guidelines

To qualify for funding the following criteria must be met:

- Project types must fall into one of the categories noted in the table above.
- Projects must demonstrate an improvement to local surface water and/or groundwater quality and/or result in an increase in natural areas cover.
- The landowner must demonstrate good land stewardship practices.
- The landowner must contribute financially to the project (see table above).
- The landowner must complete a Clean Water ~ Green Spaces Project application form.
- Other grant programs (e.g., Environmental Farm Plan) can be used to top up ERCA's Clean Water ~ Green Spaces Program. Total grant dollars cannot exceed the cost of the project.

How to Apply for Grants

- Obtain specific program information from ERCA to determine if your project qualifies.
- Complete a Clean Water ~ Green Spaces application form.
- A site visit from ERCA staff will be necessary to determine eligibility, and again following project completion. **Do not start your project until you have written approval from ERCA. Projects initiated prior to written approval are not eligible for the grant program.**
- Projects that will result in the best benefits to water quality and fish and wildlife habitat will be prioritized for funding.
- All applications will be reviewed by an Evaluation Committee.

Clean Water ~ Green Spaces Water Quality & Natural Areas Restoration Grant

Eligibility Criteria

Tree plantings

Project Details

- in kind costs can be included as eligible expenses only if the project retires at least one acre (0.4 hectare) of cultivated farmland
- all projects must include a minimum of 500 trees or shrubs.
- a \$102.00 per acre minimum cash contribution is required for all tree planting projects (not including Buffer strips and wind breaks).
- accepted tree planting practices will apply for all applications (e.g., appropriate site preparation, spacing, diverse plantings etc.)
- seedling trees only will be funded (not large stock or potted stock)
- preference will be given to those applications that take into consideration water quality improvement, wildlife habitat and the creation/joining of wildlife corridors
- only native species are eligible
- tree plantations that retire fragile land will be given preference over applications that are not on marginal lands
- preference will be given to those projects that incorporate a maintenance program e.g. mowing

Eligible project costs will include:

- design, plant material and labour costs
- tree protection systems (guards, etc.)
- in kind labour and machinery costs based on attached Eligible Expenditure Guidelines for projects larger than 1 acre (0.4 hectare)

Ineligible costs (expenses not covered by a grant):

- commercial stock, Christmas tree, fruit tree or other species which are economically marketable in less than 10 years
- in kind land value
- all in kind contributions on projects retiring less than 1 acre (0.4 hectare) of cultivated farmland

Windbreaks

Project Details

- in kind costs can be included as eligible expenses only if the project retires at least one acre (0.4 hectare) of cultivated farmland
- all projects must include a minimum of 500 trees or shrubs if planted by ERCA.
- accepted tree planting practices will apply for all applications (e.g., appropriate site preparation, spacing, etc.)
- a distance of not less than 1 meter will be left between the tree row and the cultivated crop. Distances of less than 1 meter at any point in the row will result in the Seedling Survival Guarantee being null and void.
- the landowner agrees to leave marker flags in the tree row for a minimum of 3 years. Removal will result in the Seedling Survival Guarantee being null and void.
- the landowner agrees to implement a regular maintenance program of mowing on each side of every row. Failure to have mowed by July 15 will result in the Seedling Survival Guarantee being null and void.
- seedling trees only will be funded (not large stock or potted stock)
- preference will be given to those applications that take into consideration wildlife habitat and the creation/joining of wildlife corridors
- native species will be planted unless such species are not suitable for the application
- preference will be given to windbreaks in combination with buffers that are at least 9 metres (30 feet) in width and consist of multiple tree rows and diverse species
- tree plantations that retire fragile land will be given preference over applications that are not on marginal lands
- grant amount will not exceed the cash costs to the landowner plus pre-approved in kind contributions for labour and machinery as per Eligible Expenditure Guidelines (see attached)

Eligible project costs will include:

- design, plant material and labour costs
- tree protection systems (guards, etc.)
- in kind labour and machinery costs based on attached Eligible Expenditure Guidelines for projects larger than 1 acre (0.4 hectare)

Ineligible costs (expenses not covered by a grant):

- commercial stock, Christmas tree, fruit tree or other species which are economically marketable in less than 10 years
- in kind land value
- all in kind contributions on projects retiring less than 1 acre (0.4 hectare) of cultivated farmland

Buffer Strips

Project Details

- in kind costs can be included as eligible expenses only if the project retires at least one acre (0.4 hectare) of farmland
- buffers must be a minimum of 1.5 metres (5 feet) in width
- preference will be given to those buffers that are 3 metres (10 feet) or wider with 9 metres (30 feet) or more given highest priority
- buffer strips can be combined with other projects e.g. rock chutes.
- grant amount will not exceed the cash costs to the landowner plus pre-approved in kind contributions for labour and machinery per attached Eligible Expenditure Guidelines for projects larger than 1 acre (0.4 hectare)

Eligible project costs will include:

- design, plant material and labour costs of buffer strips
- tree protection systems (guards, etc)
- in kind labour and machinery costs based attached Eligible Expenditure Guidelines for projects larger than 1 acre (0.4 hectare)

Ineligible costs (expenses not covered by a grant):

- commercial stock, Christmas tree, fruit tree species or other species which are economically marketable in less than 10 years
- in kind land value
- all in kind contributions on projects retiring less than 1 acre (0.4 hectare) of cultivated farmland

Agricultural Soil Erosion Control Structures (e.g. Rock Chutes)

All projects must be pre-approved before work is started.

Project Details

- only structures that reduce soil erosion from agricultural fields will be funded.
- all rock chutes must be installed according to accepted practices e.g., gabion rip rap stone with a filter fabric layer, appropriate slopes, etc. Please refer to Rock Chute Installation sheet.
- preference will be given to those applications that incorporate a buffer and/or windbreak
- liaison with the municipal Drainage Superintendent is recommended and may be required
- grant amount will not exceed the cash costs paid by the landowner plus pre-approved in kind contributions for labour and machinery, **based on a maximum cost of \$5.00/sq.ft. of finished rock chute.**

Agricultural Soil Erosion Control Structures (e.g. Rock Chutes) - continued

Eligible project costs will include:

- professional design, labour, material and equipment
- in kind labour and machinery cost per attached Eligible Expenditure Guidelines.

Ineligible costs (expenses not covered by a grant):

- in kind land value
- any costs involving new or re-tiling including header lines.
- rock chutes at lateral tile ends

Abandoned Water Well Plugging

All projects must be pre-approved before work is started.

Project Details

- wells must be plugged by a Ontario Ministry of the Environment licenced well contractor
- projects must comply with Ontario Ministry of the Environment procedures for plugging an unused water well according to Ontario Regulation 903; details of the procedure must be documented on an Ontario Ministry of the Environment Water Well Record and a copy submitted to ERCA.

Eligible project costs will include:

- licensed contractor fees
- labour and material associated with proper well plugging procedures

Ineligible costs (expenses not covered by a grant):

- labour and machinery costs other than those of a licensed contractor
- in kind contributions

Clean Water ~ Green Spaces Program
In Kind Landowner Contributions
Eligible Expenditure Guidelines

The rates included in the table below should be used by landowners when calculating their in-kind contributions to projects. Information on whether your project qualifies for in-kind contributions is outlined in the *Eligibility Guidelines* section of the application package. Rates are based on Ontario Ministry of Agriculture, Food and Rural Affairs Custom Rate Schedule and Essex Region Conservation Authority Fee Schedule.

Project Type	Activity	Specifications
Rock Chutes	Backhoe	Up to \$75/hour (includes equipment & operator)
	Excavator	Up to \$130/hour (includes equipment & operator)
	Rock	\$20/ton (including trucking)
Tree Planting/ Buffer Strip/ Windbreak	Ploughing	Minimum \$118 or \$25/acre (includes operator)
	Discing or Roto tilling	Minimum \$199 or \$17/acre (includes operator)
	Broadcast seeding	Minimum \$115 or \$6/acre (includes equipment & operator)
	Drill seeding	Minimum \$255 or \$21/acre (includes equipment & operator)
	Pasture seed mix	\$2/lb at 10 to 35 lbs/acre
	Clover seed	\$3.50/lb at 8 to 15 lbs/acre
	Tree planting	\$0.65/seedling
	Spraying rows of trees (pre-emergent herbicide)	\$0.15/seedling (includes chemical, equipment & operator)
	Site burn down (Pull type sprayer) (broad spectrum herbicide)	Minimum \$310 or \$9/acre (includes chemical, equipment & operator)
	Mowing between rows of trees	\$15/acre (based on 2-3 times/year for 2 years) (includes equipment & operator)

Sample Location Map

Property Owner: _____

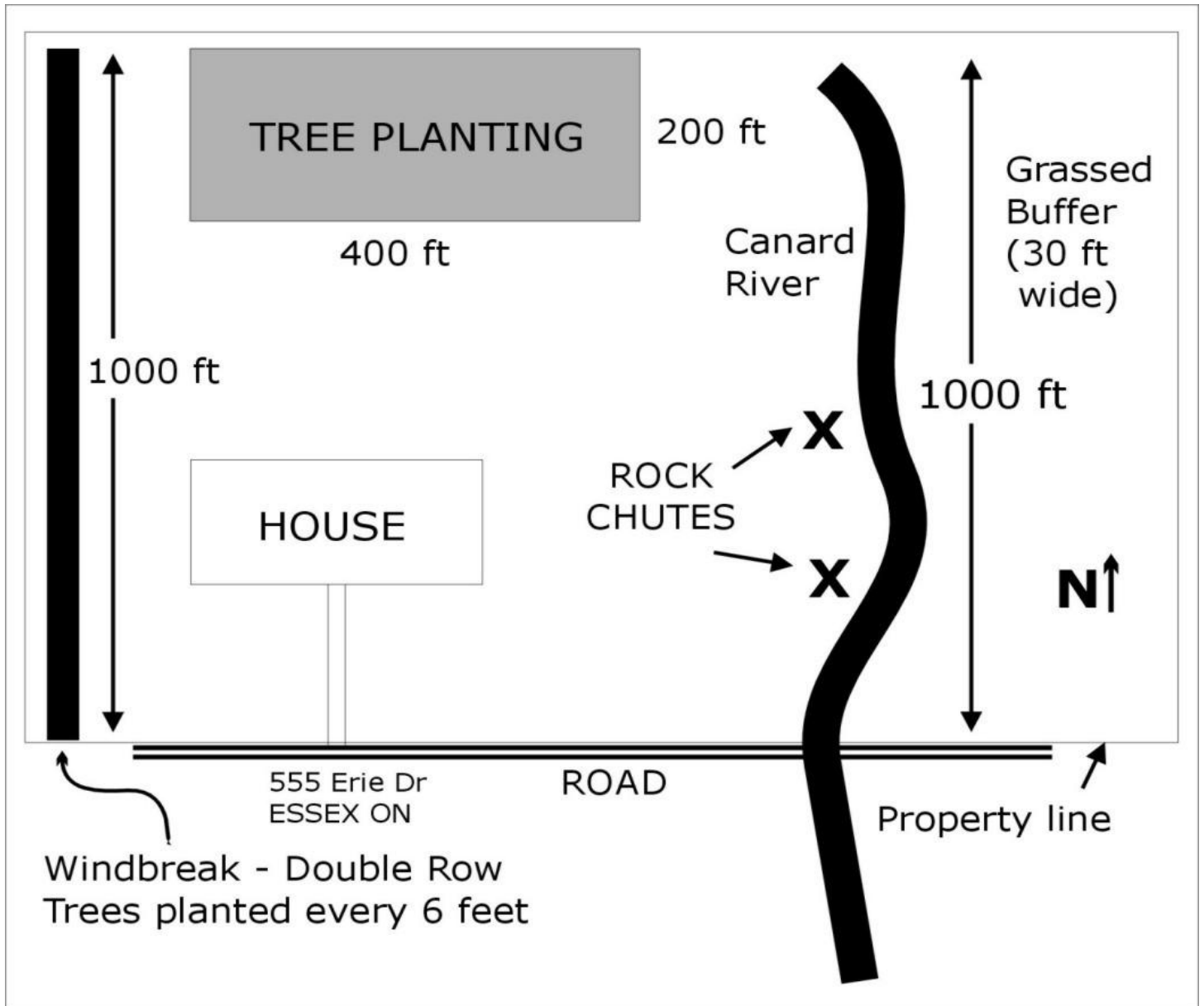

Please make a sketch drawing of the proposed project outlining the road, the land marks on the property (barns, house, etc.) and the 911 of the nearest dwelling.

Note location of proposed project works.

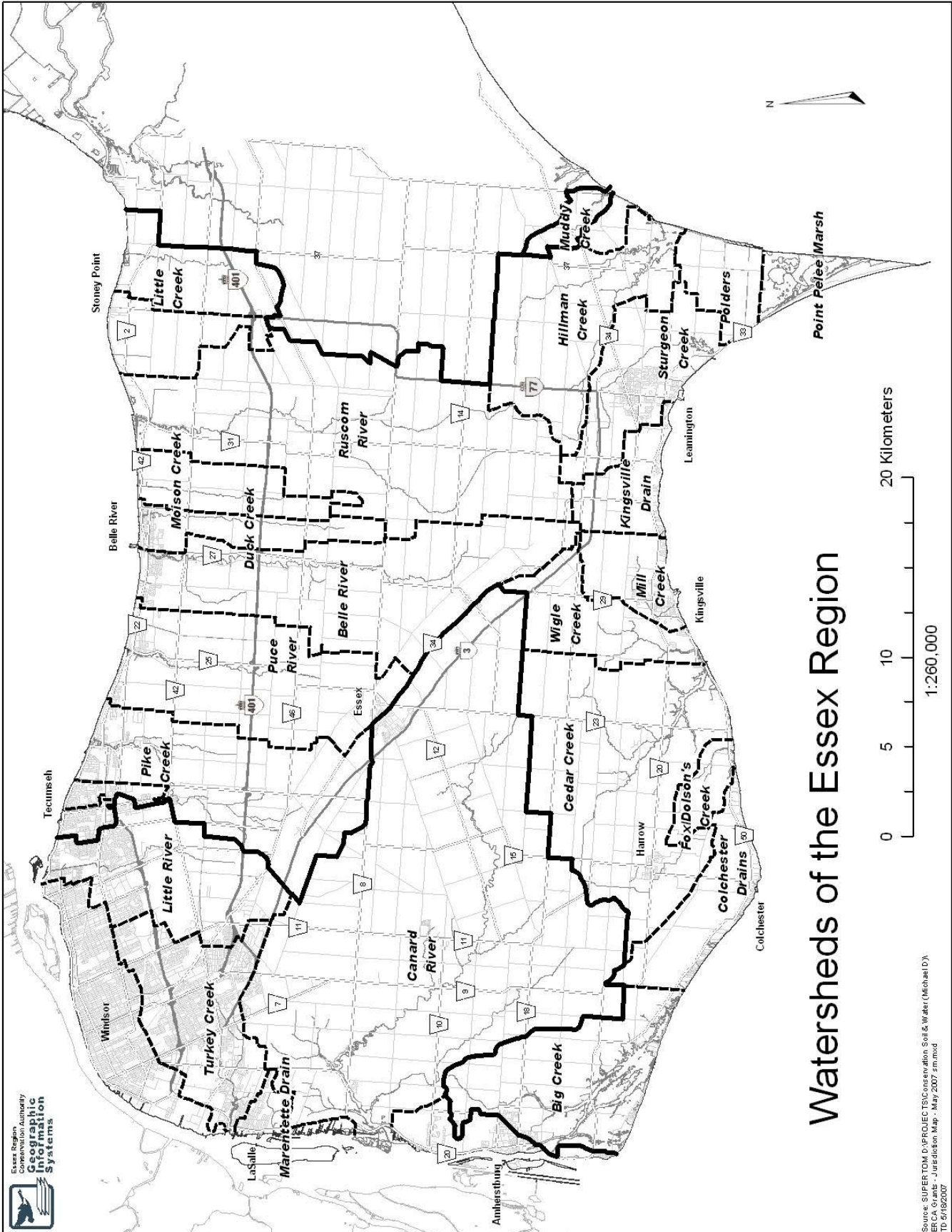

Watersheds of the Essex Region



Source: SUPER.TOM.D.V.PROJECTS/Conservation Soil & Water (Michael D.Y.)
 ERCA Grants - Jurisdiction Map - May 2007 sm.mod
 TD: 5/18/2007